

Components

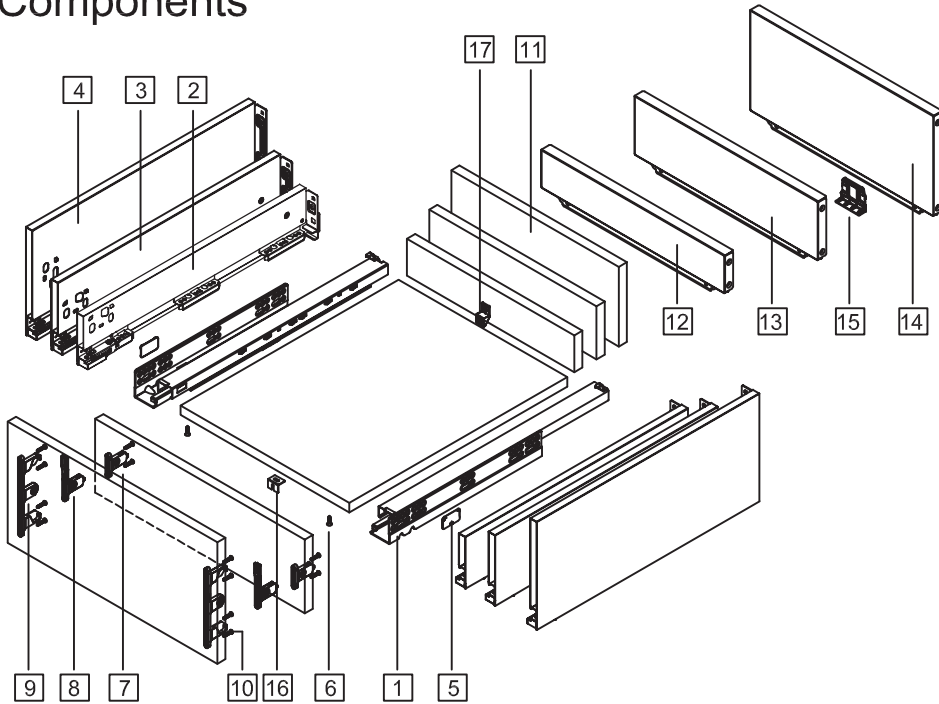

1. Cabinet profiles: L/R	10. Front fixing-brackets screw (Ø4x17)
2. 89 Drawer profiles: L/R	11. Drawer back
3. 121 Drawer profiles: L/R	12. Metal back height 89
4. 185 Drawer profiles: L/R	13. Metal back height 121
5. Side cover plate	14. Metal back height 185
6. Bottom screw (Ø3.5x15)	15. Metal back fixed
7. 89 Front fixing-brackets	16. Bottom fixing (for wide drawer)
8. 121 Front fixing-brackets	17. Back fixing (for wide drawer)
9. 185 Front fixing-brackets	

Nominal length	Internal drawer length	Min. installation length of drawer
270mm	244mm	275mm
300mm	274mm	305mm
350mm	324mm	355mm
400mm	374mm	405mm
450mm	424mm	455mm
500mm	474mm	505mm
550mm	524mm	555mm

Drawer Back and Bottom Dimensions

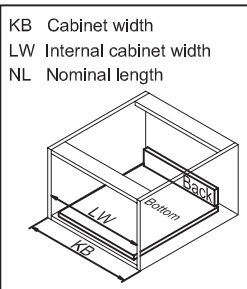
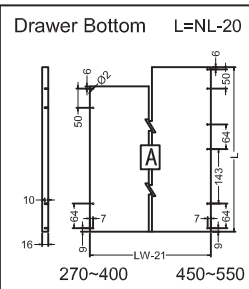
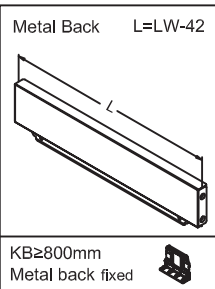
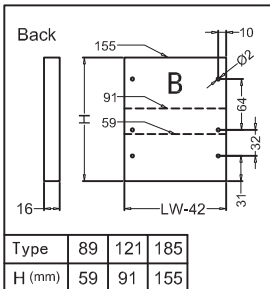

Installation dimensions (mm)

Nominal slide length = NL Internal cabinet depth = LT

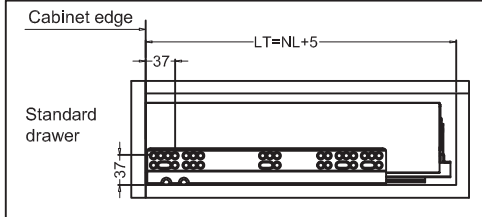

Drawer installation dimensions (mm)

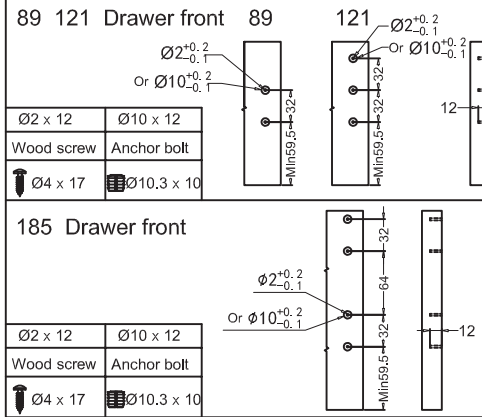

Screw positions of the sides

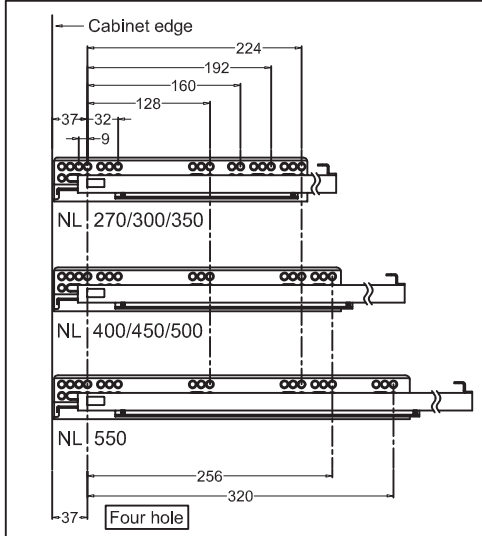

Drawer installation dimensions (mm)

LW = Internal cabinet width

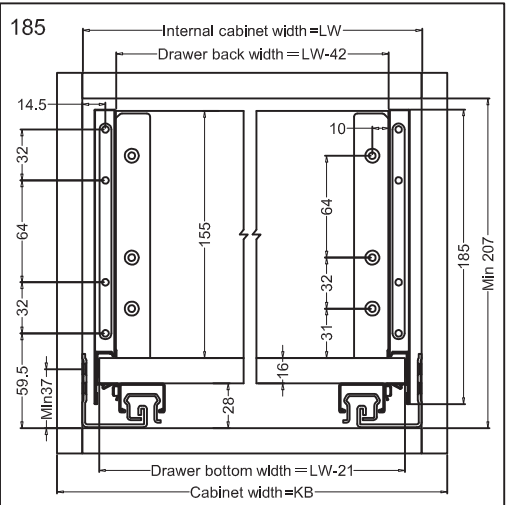
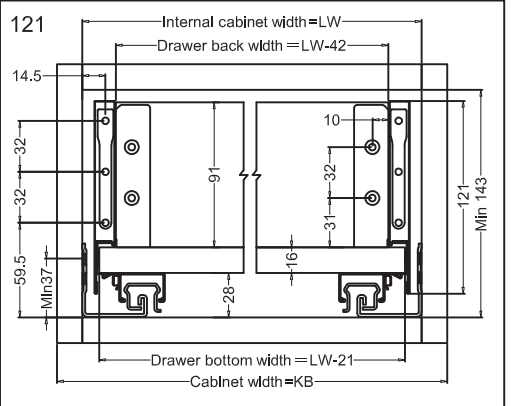
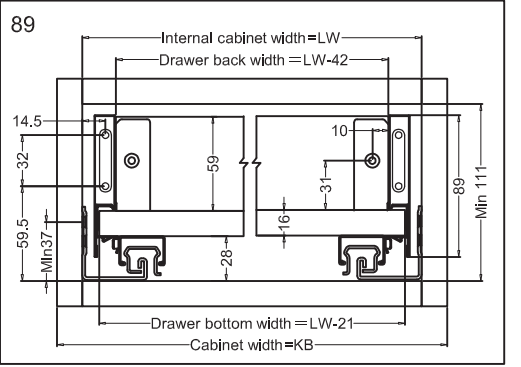

Series slender metal drawer
Assembly removal and adjustment



Drawer assembly

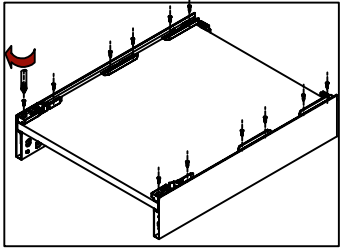

Bottom assembly

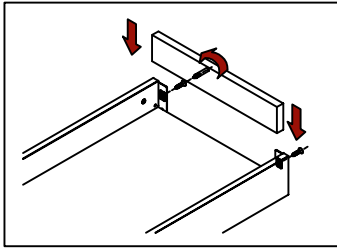

Back assembly

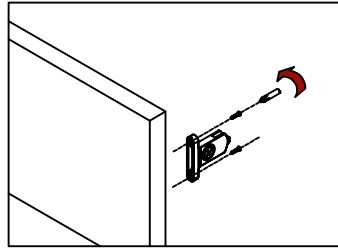

89 Front assembly

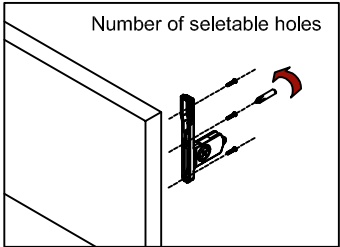

121 Front assembly

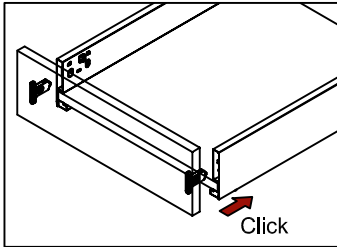

Click

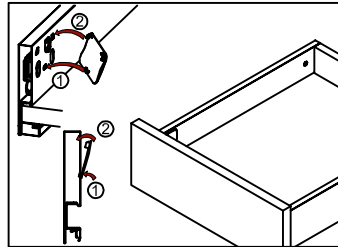

Adjustment

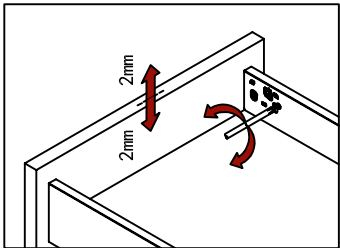

Up&down adjustment

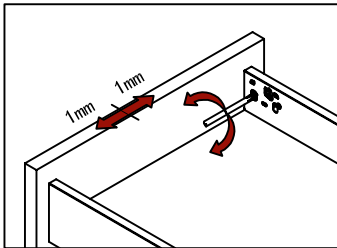

Left&right adjustment

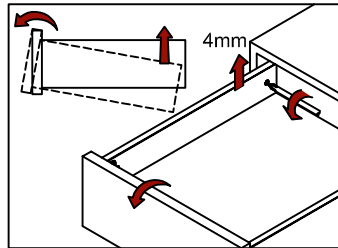

Front slope angle adjustment

Removal

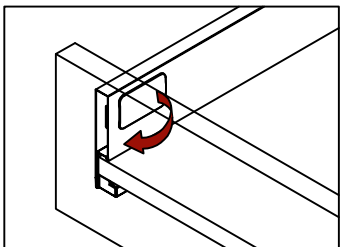

Tip up the cover and pull out

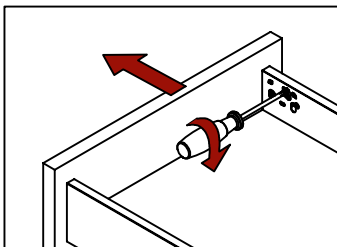

Removal drawer front

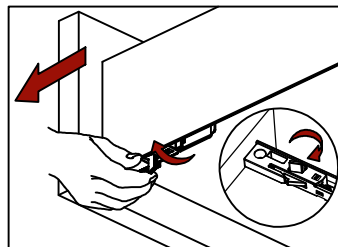

Removal drawer

Series slender metal drawer
Assembly removal and adjustment



Drawer assembly

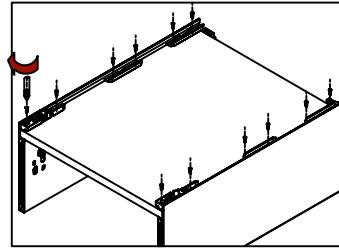

Bottom assembly

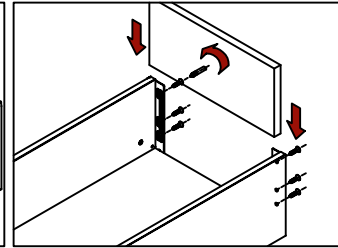

Back assembly

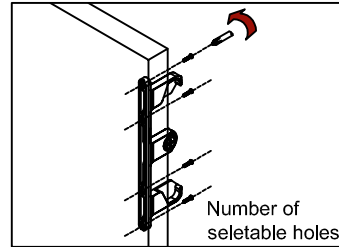
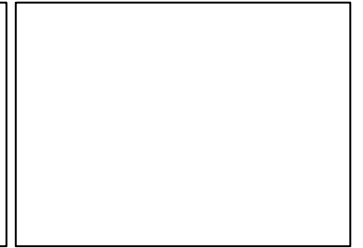

Front assembly

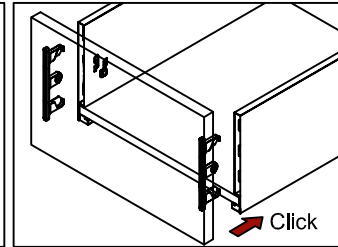

Click

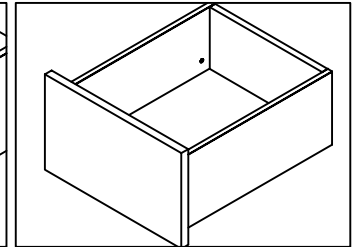

Adjustment

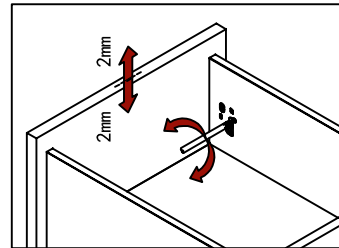

Up&down adjustment

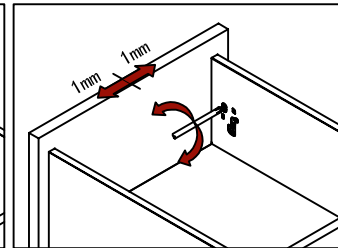

Left&right adjustment

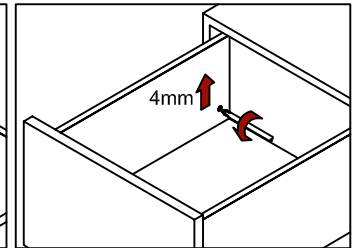

Front slope angle adjustment

Removal

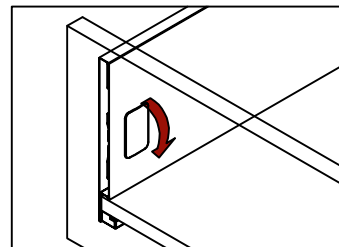

Tip up the cover and pull out

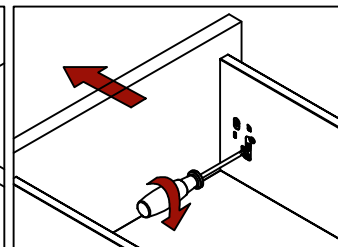

Removal drawer front

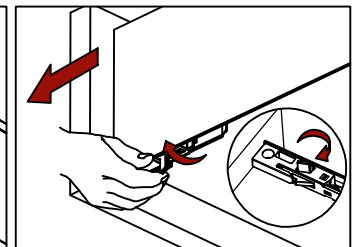

Removal drawer